

Product Description

StanPro produces injection molded components in an unlimited array of designs for a wide range of applications. Our injection molding processes yield components for fluid and air delivery systems.

StanPro components are lightweight, flexible in configuration, easy to assemble, serviceable, and complementary to other components. Our components can accommodate various plastic or steel tubing. Our philosophy is to maximize design efforts to minimize component complexity, allowing you the greatest flexibility in design and minimum effort in assembly.

Product Benefits

- Lightweight & Cost-effective
- Flexible in configuration and application
- Simpler by design
- Easy to assemble
- Serviceable when desired.
- Complementary to other components minimizing component count

Applications

- Connections: tubes, hoses, conduit
- Closing or end-capping
- Mounting clips
- Fasteners

Barbed Types

Connectors are available with various barbed types as shown below.

Single Barb
(Air)



Double Barbed
(Air, vapor or fuel)



Triple Barbed
(Air, vapor or fuel)



Design Features

Clips are multi-functional and can be made from molded plastic or as a metal-plastic combination.

Two Tube Foldover Clip
with "Christmas Tree"
(push-pin rivet mount)

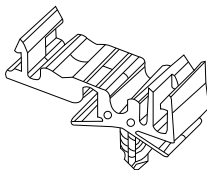

Four Tube Spacer Clip

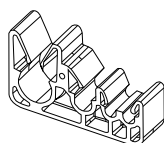

75003142



75003139



75003149



75003131

75003120

